

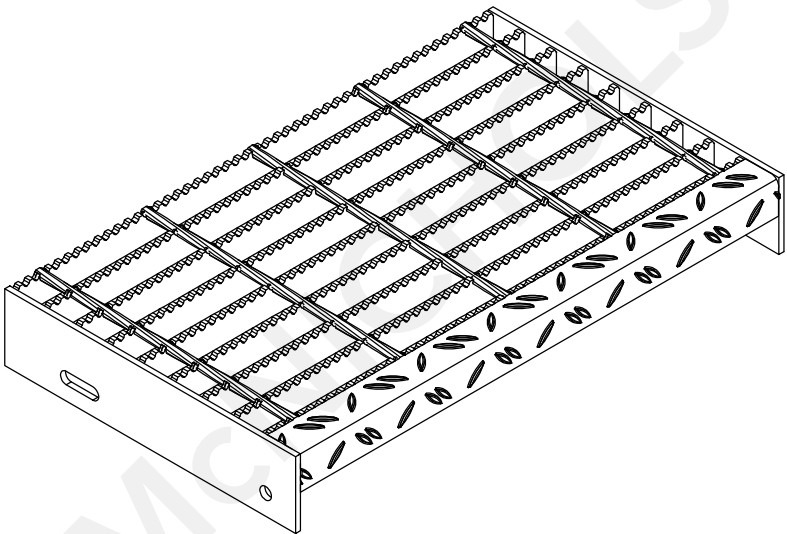

Bar Grating

Top View

End View

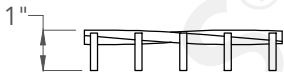
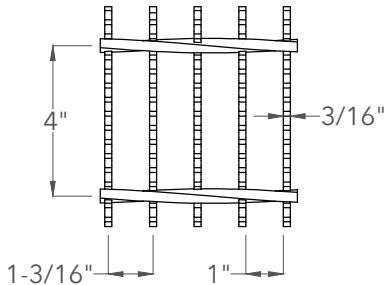

Nosing

Top View

Front View

End View

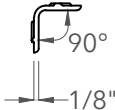

Carrier Plate

Side View

End View

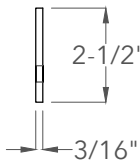
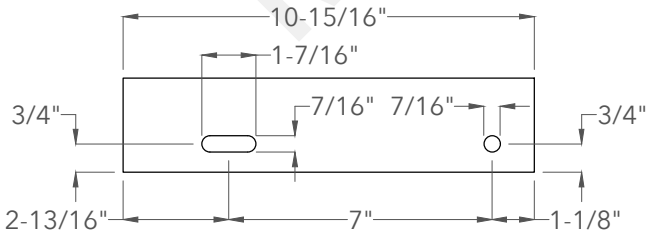

800.237.3820
mcnichols.com

Drawing is for visual and conceptual purposes, is not to scale, and is based on nominal manufacturing data subject to standard production tolerances. McNICHOLS CO. does not provide engineering services of any kind. Technical information provided is for evaluation by technically skilled persons only, with any use thereof to be at their independent discretion and risk. McNICHOLS CO. shall have no responsibility or liability for results obtained or damages resulting from improper evaluation or use. McNICHOLS CO. makes no representation or warranty of any kind, express or implied, at law or in equity, regarding drawing including with respect to merchantability, fitness for any particular use or purpose, or design. All other representations or warranties are hereby disclaimed. This document and other related documents are subject to McNICHOLS CO. Terms and Conditions.

McNICHOLS® STAIR TREADS

MAIN PRODUCT LINE	Bar Grating
SERIES TYPE & NAME	Bar - GW-100 (Standard-Duty Welded)
PRODUCT SPACING	19-W-4
PRIMARY MATERIAL	Galvanized Steel
BEARING BAR SIZE & SHAPE	1" Height x 3/16" Thick Rectangular Bar
BEARING BAR SPACING	1-3/16" on Center
CROSS BAR SPACING	4" on Center
PRODUCT SURFACE	Serrated
NOSING	Checkered Plate 90° Angle Nosing (1-1/4" Leg x 1-1/4" Leg)
CARRIER PLATE	CP-BG-1025 Bar Grating Stair Tread Carrier Plates - Pair (2-1/2" Height x 10-15/16" Width)

DRAWING

NOT TO SCALE

Item Number 640131R1
Revision Date 09.11.2025
Page Number 1 of 1

© 2025 McNICHOLS CO.
All Rights Reserved.