

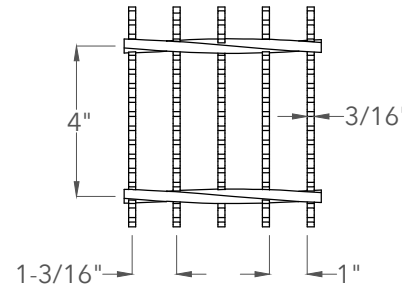

Bar Grating

Top View



End View

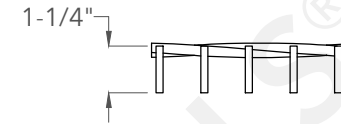

Nosing

Top View



Front View



End View

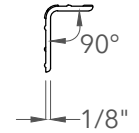

Carrier Plate

Side View

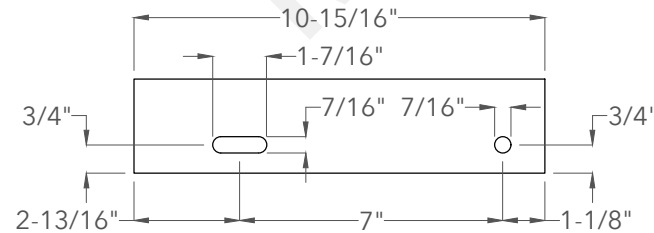

End View

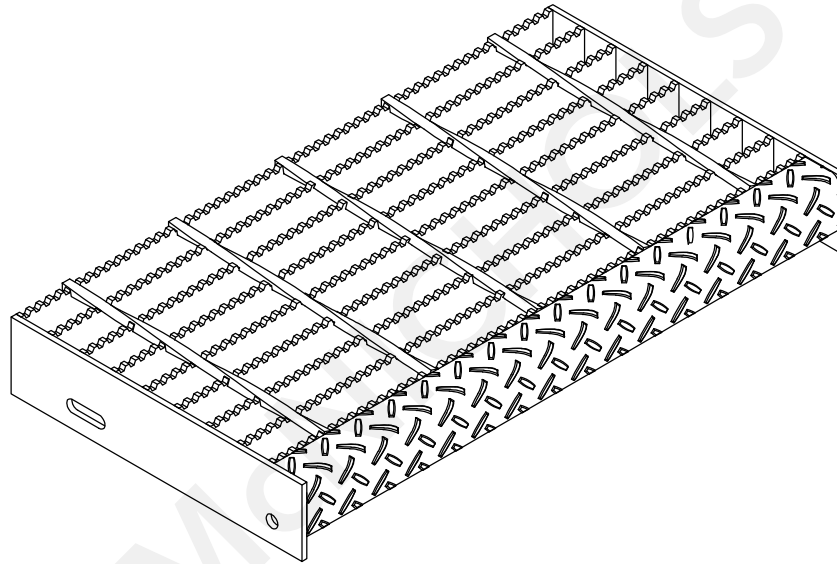
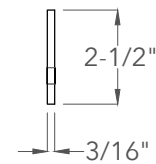

800.237.3820
mcnichols.com

McNICHOLS® STAIR TREADS

MAIN PRODUCT LINE
SERIES TYPE & NAME
PRODUCT SPACING
PRIMARY MATERIAL
BEARING BAR SIZE & SHAPE
BEARING BAR SPACING
CROSS BAR SPACING
PRODUCT SURFACE
NOSING
CARRIER PLATE

Bar Grating
Bar - GW-125 (Standard-Duty Welded)
19-W-4
Carbon Steel
1-1/4" Height x 3/16" Thick Rectangular Bar
1-3/16" on Center
4" on Center
Serrated
Checked Plate 90° Angle Nosing (1-1/4" Leg x 1-3/4" Leg)
CP-BG-1025 Bar Grating Stair Tread Carrier Plates - Pair
(2-1/2" Height x 10-15/16" Width)

DRAWING

NOT TO SCALE

Item Number 660431T6
Revision Date 08.09.2024
Page Number 1 of 1

© 2024 McNICHOLS CO.
All Rights Reserved.

Drawing is for visual and conceptual purposes, is not to scale, and is based on nominal manufacturing data subject to standard production tolerances. McNICHOLS CO. does not provide engineering services of any kind. Technical information provided is for evaluation by technically skilled persons only, with any use thereof to be at their independent discretion and risk. McNICHOLS CO. shall have no responsibility or liability for results obtained or damages resulting from improper evaluation or use. McNICHOLS CO. makes no representation or warranty of any kind, express or implied, at law or in equity, regarding drawing including with respect to merchantability, fitness for any particular use or purpose, or design. All other representations or warranties are hereby disclaimed. This document and other related documents are subject to McNICHOLS CO. Terms and Conditions.